

pizazz



# edge·mounts

Designed for artwork, photography, etc

[www.pizazzsystems.com](http://www.pizazzsystems.com)



display your valuable graphics  
with this elegant system



# pizazz edge·mounts



UNIQUE  
\* PATENTED \*  
FUNCTIONALITY

Edgemounts minimalist design mean they don't compete with your graphics for visual attention. They also give you the option to install back panels to enhance the visual impact.

## Display Options

### Without Borders

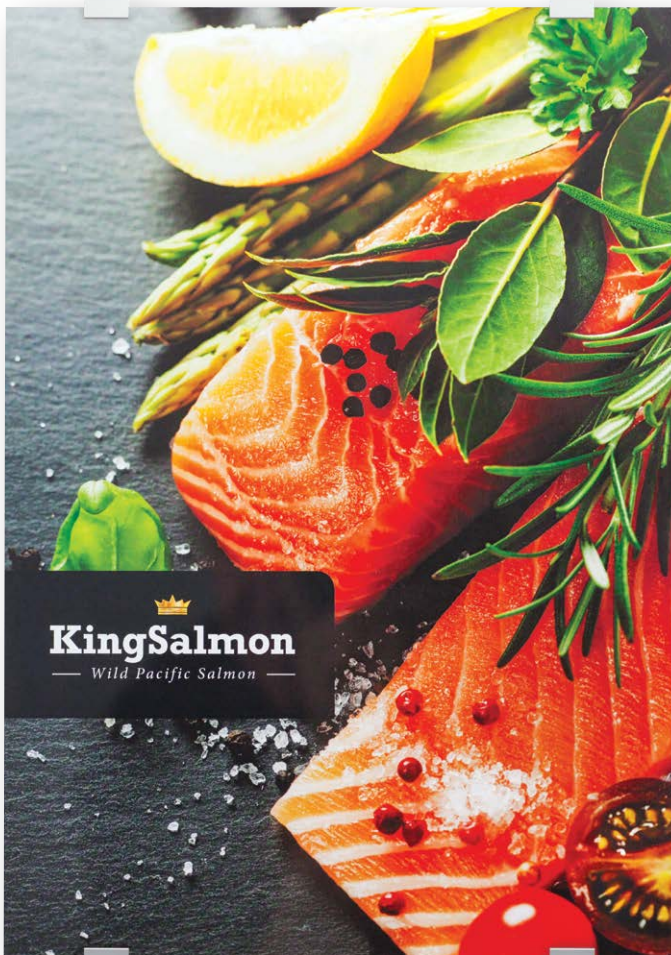

Image printed on paper and displayed between a back panel and a clear acrylic front panel



Image printed on the front of a panel

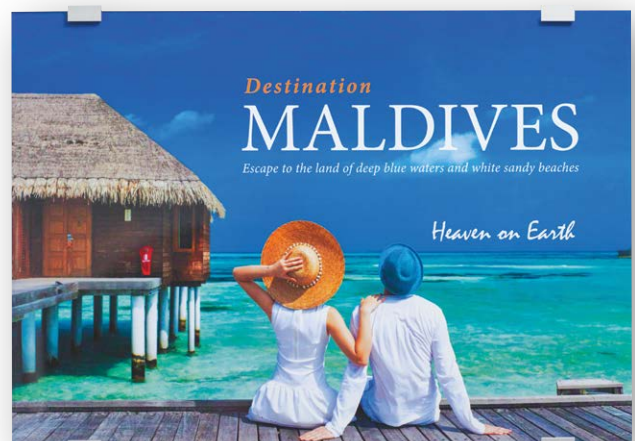

Image printed on the back of a clear acrylic panel

## Installation

### Without a border

#### Important:

Use approved wall anchors when required.

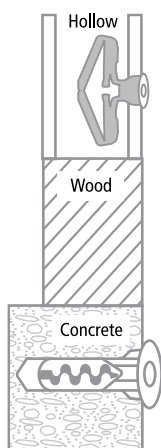

The internal back wall of **G Parts** accommodates an 8 or 9 gauge countersunk screw or bolt.

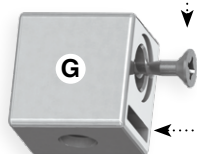

**H Part** screws into the **G Part** to secure the **L Part**.

#### BACK PANEL

**Option 1.**  
Graphic image printed on the back or front of the back panel.

#### GRAPHIC IMAGE

**Option 2.**  
Graphic image held between the back panel and a clear front panel.

#### FRONT PANEL



**L Part** slots into the **G Part**.

The graphic image panel sits on the **L Part** and is secured in the **G Part**.

Final Assembly Position



pizazz  
edge·mount



UNIQUE  
\* PATENTED \*  
FUNCTIONALITY

display your valuable graphics with this elegant system

## Display Options

With back panels that create coloured borders to enhance the visual impact



Satin silver back panel - matching the colour of the edgemounts

## Installation

With a border

### Important:

Use approved wall anchors when required.

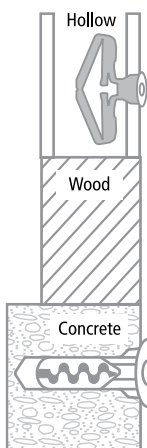

The internal back wall of **G Parts** accommodates an 8 or 9 gauge countersunk screw or bolt.

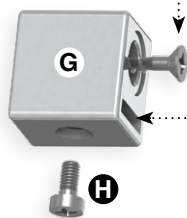

**H Part** screws into the **G Part** to secure the **L Part**.

### BACK PANEL

**Option 1.**  
Graphic image printed on the back or front of the back panel.

### GRAPHIC IMAGE

**Option 2.**  
Graphic image held between the back panel and a clear front panel.

### FRONT PANEL



**I Part** screws into the **G Part**.



**L Part** slots into the **G Part**.

The back panel is secured to the **G Part** with the **I Part**. The front panel sits on the **L Part** and is secured against the back panel.

Final Assembly Position



See our innovative Monomount and Multimount standoff systems at: [www.pizazzsystems.com](http://www.pizazzsystems.com)

Pizazz is a registered trademark of Pizazz Group Limited. © 2019



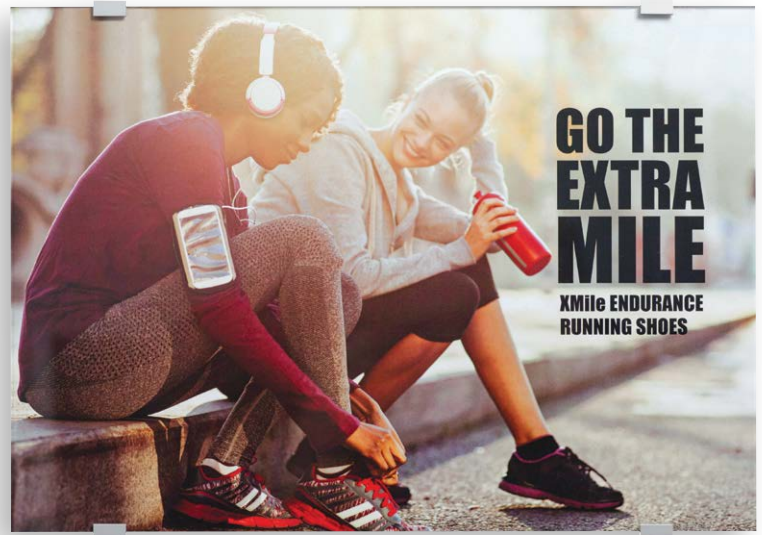

## Technical Information

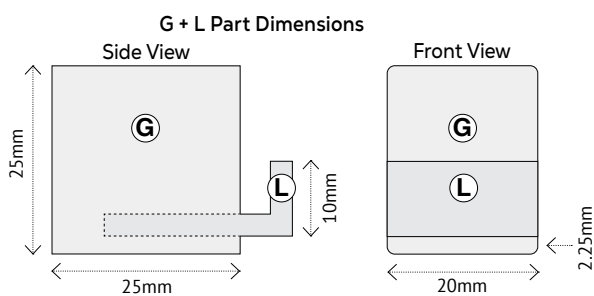

## Back Panel Hole + Slot Dimensions

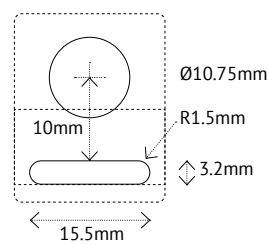

## Panel Thickness

